

- 1 HOUSING MATERIAL: THERMOPLASTIC.
- 2 CONTACT MATERIAL: BERYLLIUM COPPER.
- 3 CONTACT FINISH: .000050-.000100 NICKEL UNDERPLATE ALL OVER WITH .000030 GOLD IN CONTACT AREA AND .000100-.000200 TIN-LEAD PLATED POSTS.

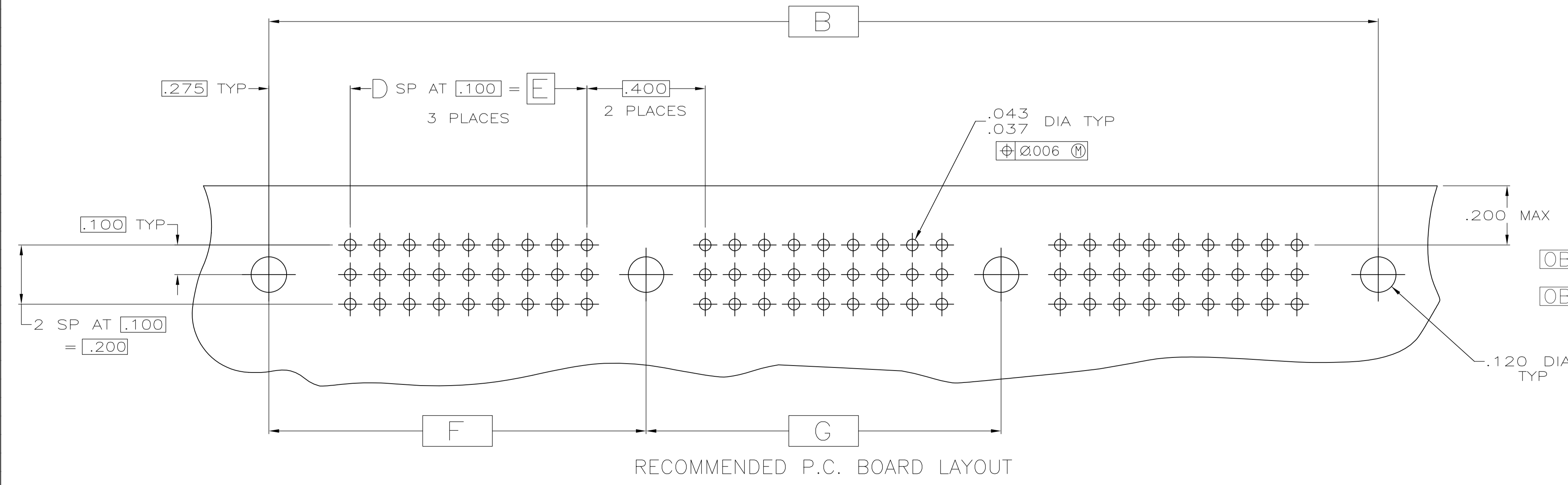
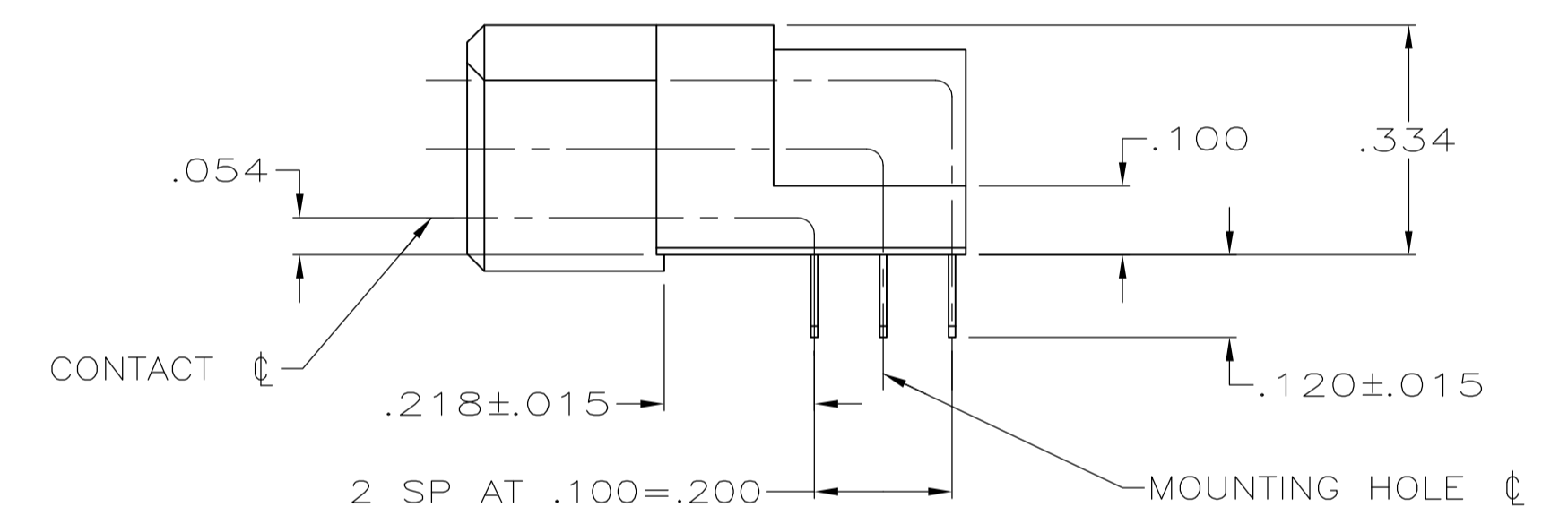
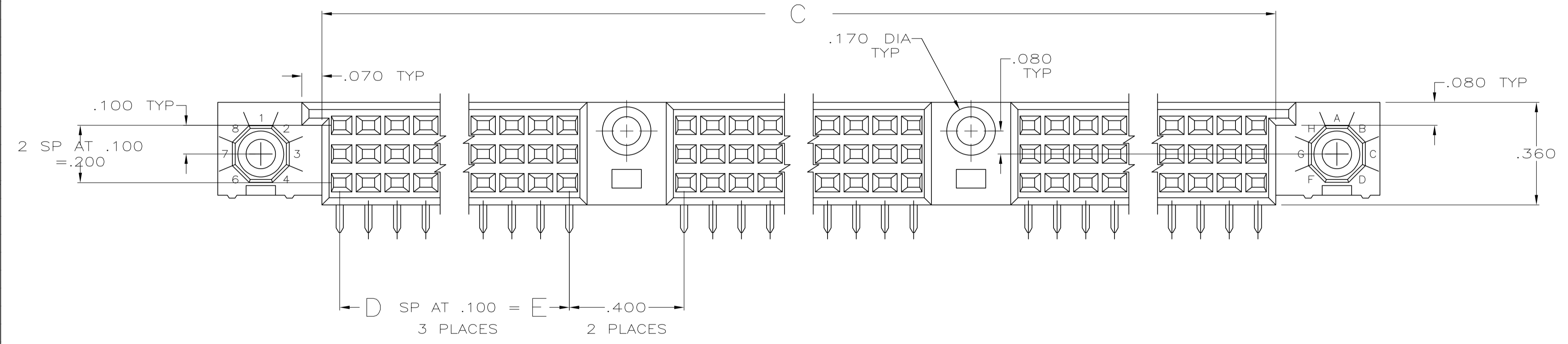
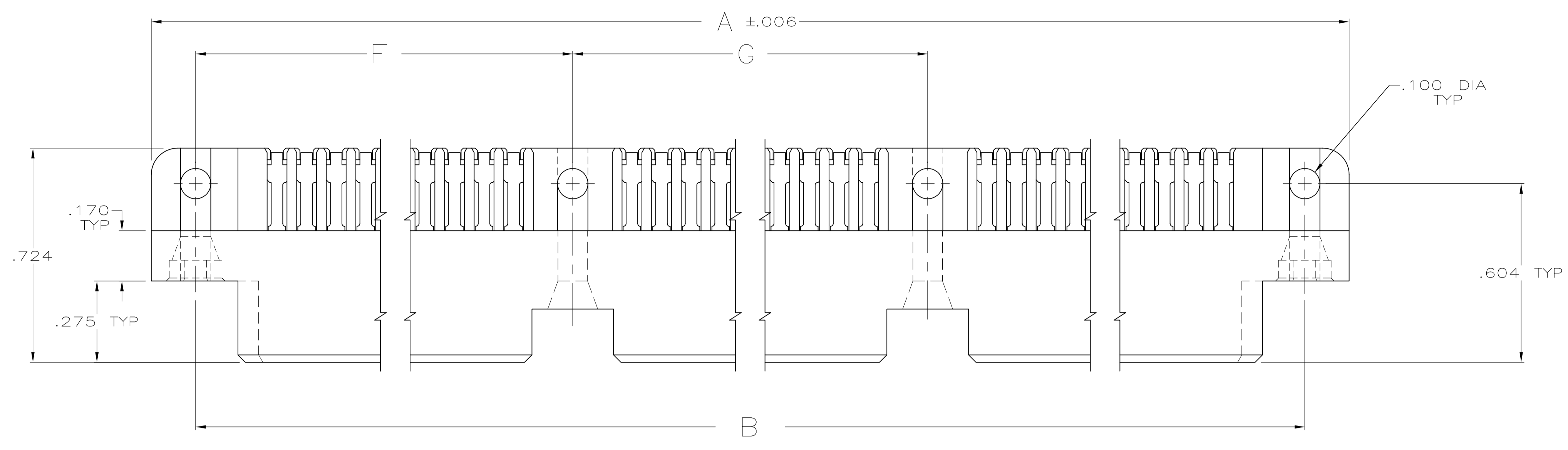

OBSELETE	4.800	4.875	4.400	44	14.124	14.550	14.850	405	534042-3
	5.000	5.075	4.600	46	14.724	15.150	15.450	423	534042-2
OBSELETE	4.600	4.675	4.200	42	13.524	13.950	14.250	387	534042-1
	G	F	E	D	C	B	A	NO OF POSN	PART NUMBER

THIS DRAWING IS A CONTROLLED DOCUMENT.

DIMENSIONS: INCHES	TOLERANCES UNLESS OTHERWISE SPECIFIED:	0 PLC ± -	1 PLC ± -	2 PLC ± -	3 PLC ± .005	4 PLC ± -	ANGLES ± -
MATERIAL	FINISH	WEIGHT	SIZE	CAGE CODE	DRAWING NO	RESTRICTED TO	
1/2	3		A1	00779	534042		

CUSTOMER DRAWING SCALE 4:1 SHEET 1 OF 1 REV H1